

ALFA

CONVERSION KIT AUSTRALIA







Index

| | |
|-----------|---|
| 05 | REGULATOR CONVERSION INSTRUCTIONS |
| | BURNER CONVERSION |
| 06 | MODERNO 2 E 3 PIZZE - CLASSICO 2 E 4 PIZZE |
| 10 | MODERNO 1 E 5 PIZZE - FUTURO 2 E 4 PIZZE |

WARNING

The conversion must be performed by qualified technicians when the oven has completely cooled down. Improper installation, adjustment or maintenance can cause property damage or personal injury.

**ONLY USE THE COMPONENTS
AND PARTS SUPPLIED BY ALFA FORNI.**

LPG/NG CONNECTION AND INSTALLATION



LPG CONNECTION

- A** REGULATOR CONNECT TO OVEN (supplied)
- E** 1/2" MALE GAS FITTING (3/8" OD FLARE X 1/2" MIP - TAPPED 3/8" FIP (supplied)
- F1** LPG HOSE CONNECT TO OVEN (supplied)
- F2** LPG HOSE/REGULATOR CONNECT TO PROPANE GAS CYLINDER. (supplied)

- Connect Regulator (A) to the oven.
- Connect Propane Hose (F1) to the Regulator (A) using 1/2" Male Gas
- Fitting (E) - 3/8" OD Flare x 1/2" MIP - Tapped 3/8" FIP.
- Connect Propane Hose/Regulator to Propane Gas Cylinder

*Use PTFE tape or pipe thread sealant where needed

LPG / NG REGULATOR CONVERSION INSTRUCTIONS

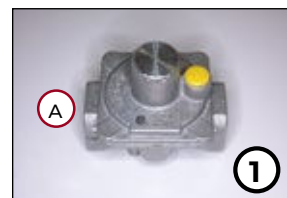

1 - BEGIN BY CONVERTING THE REGULATOR FROM LPG TO NG (H)



2 - UN SCREW THE CAP TO ACCESS THE REGULATOR ADJUSTMENT.



3 - THE PLASTIC ADAPTER SHOULD BE TURNED UPSIDE DOWN DEPENDING ON THE TYPE OF GAS SUPPLY.



4 - CONVERTING THE REGULATOR

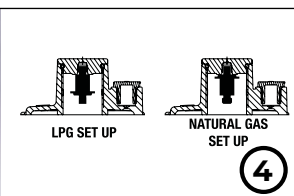

5 - REFIT THE CAP.

BURNER CONVERSION

MODERNO 2 AND 3 PIZZE - CLASSICO 2 PIZZE



1 - Close the gas

Before starting, make sure that the gas flow is stopped. Then close the gas mains tap or the LPG cylinder.

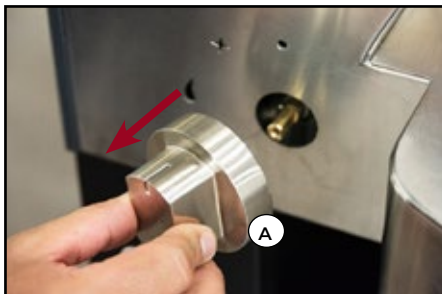

2 - Remove the gas knob

In order to remove the gas knob (A) it will be sufficient to pull it with slight force. Follow the direction of the arrow.

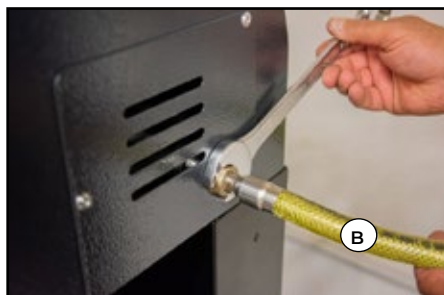

3 - Remove the gas tube

In order to disconnect the gas tube (B) you can use a 24 wrench or suitable pliers.

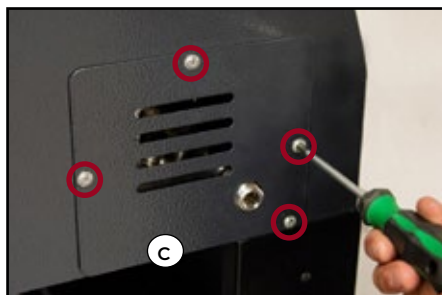

4 - Remove the protective casing

In order to remove the protective casing (C) it will be sufficient to remove the screws indicated in the photo that secure it to the oven.

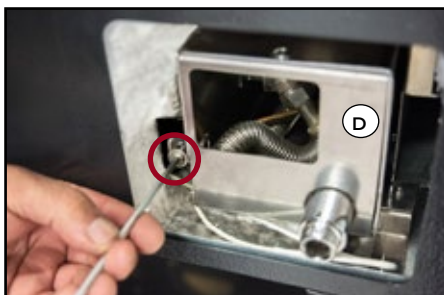

5 - Unlock the burner

In order to unlock the burner (D) simply remove the screw indicated in the red circle. Use a 4mm hex wrench.

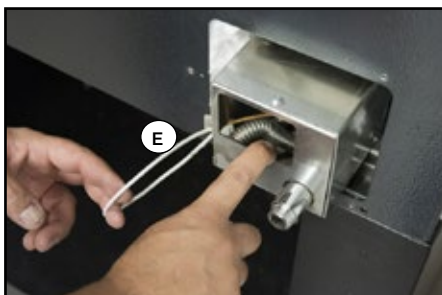

6 - Remove the burner

Now remove the burner halfway, being careful not to damage the ignition cable. (E)

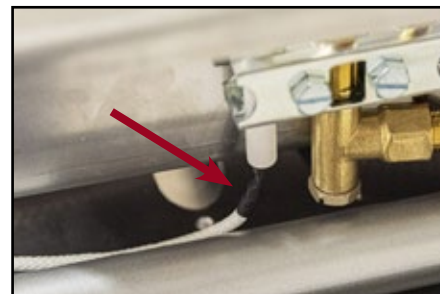

7 - Disconnect the ignition cable

At this point, looking sideways, you will have access to the assembly unit and you can disconnect the white ignition cable. You can help yourself with tweezers by gripping the black sheath.

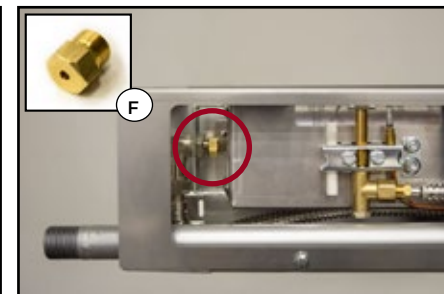

8 - Identify the nozzle to be replaced

Once the burner is removed, you will see the golden nozzle (F) that will need to be replaced.

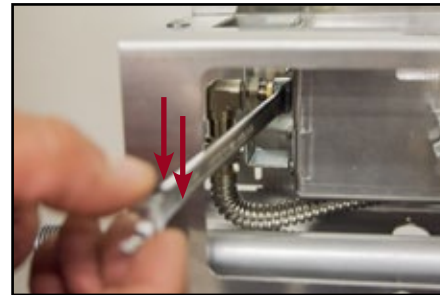

9 - Remove the nozzle

In order to remove the nozzle, use an 11 wrench by unscrewing the nozzle as if it were a normal nut. Turn the wrench from top to bottom.

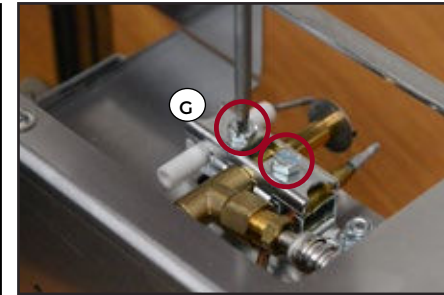

10 - Pilot group release

Remove the block (G) of the pilot group to proceed with the adjustment of the pilot flame. Just unscrew the two screws circled in red.

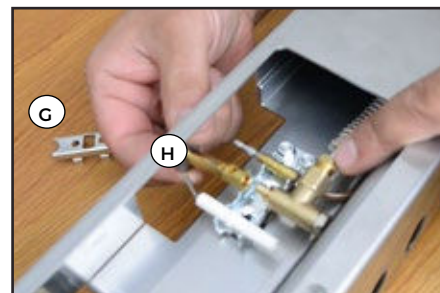

11 - Remove the pilot flame

Once the stop (G) has been removed, remove the pilot flame head (H).

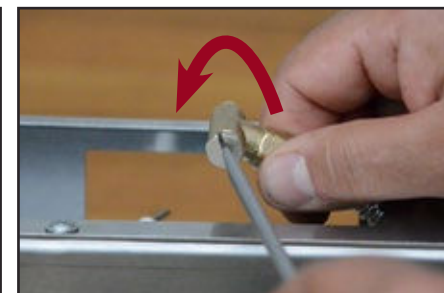

12 - We reach the nozzle

We raise the pilot flame and unscrew the cap to reach the pilot flame nozzle.

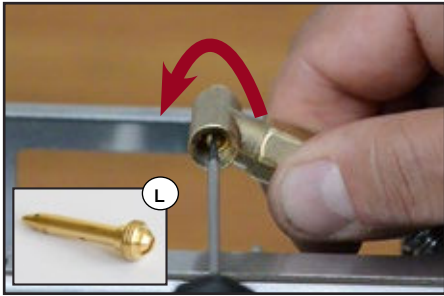

13 - Replace the pilot flame nozzle

Using a suitable screwdriver, unscrew the pilot flame nozzle **(L)** and replace it with the new nozzle.

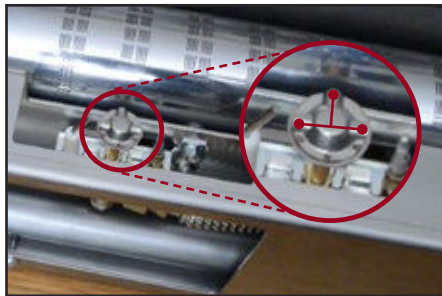

14 - Resetting the pilot flame

Reposition the pilot flame head as shown in the enlarged photo. Check that the T created by the openings respects the indicated position.

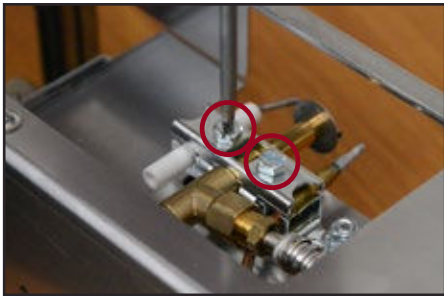

15 - Let's restore the pilot group

At this point restore the pilot assembly by repositioning the block **(G)** previously removed. Then proceed in reverse from point 7 to point 2 of the previous page.



**To watch the
conversion video**

RESTORATION OF THE BURNER

TIP: Before reassembling the burner and all its parts, ensure that the power cable is correctly connected by activating the button located at the front.

NOTE: Reinsert the knob, paying attention to the valve pin. Apply slight pressure to push the knob into place.



1 - Partially reinsert the burner

Position the burner to slide it into the guide and, through the front lower opening, insert the igniter cable. PARTIALLY insert the burner while guiding the igniter cable into place.

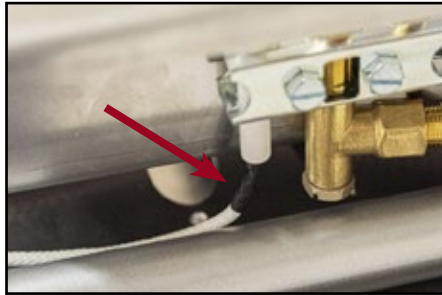

2 - Reconnect the igniter cable

Insert the igniter cable into the igniter, taking care not to damage the cable or the connection.

TIP: Before reassembling the burner and its components, verify that the power cable is correctly connected by pressing the front button.

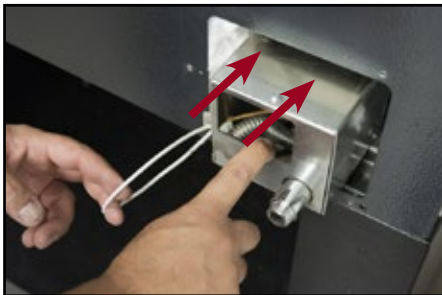

3 - Fully insert the burner

Slide the burner into the guide rail until it reaches the front stop position. Ensure the igniter cable does not become tangled.



4 - Secure the burner fixing screw

Tighten the rear screw to hold the burner firmly in place.

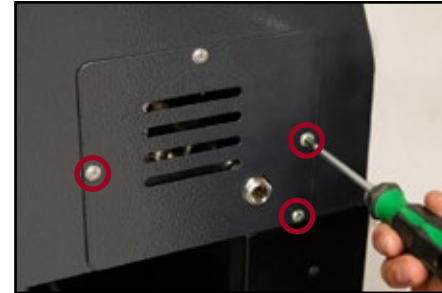

5 - Attach the protective cover

Reposition the rear burner cover and tighten the fixing screws using a Phillips screwdriver.



6 - Reassemble the gas knob

Reinsert the knob, ensuring it aligns properly with the valve pin. Apply light pressure to fully seat the knob. Ensure the knob is in the "off" position.



7 - Reconnect the gas supply hose

Reconnect the supply hose to the rear burner manifold. You can now reopen the natural gas circuit or the LPG cylinder.

BURNER CONVERSION

MODERNO 1 PIZZA



1 - Close the gas

Before starting, make sure that the gas flow is stopped. Then close the gas mains tap or the LPG cylinder.

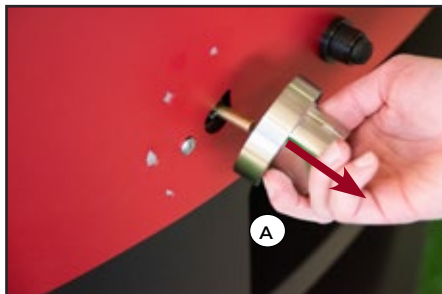

2 - Remove the gas knob

In order to remove the gas knob (A) it will be sufficient to pull it with slight force. Follow the direction of the arrow.

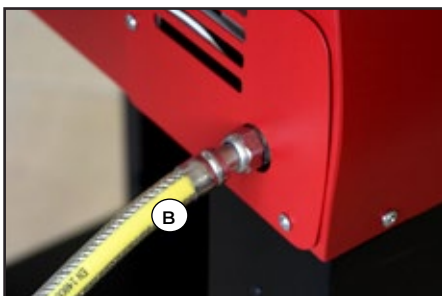

3 - Remove the gas tube

In order to disconnect the gas tube (B) you can use a 24 wrench or suitable pliers.



4 - Remove the protective casing

In order to remove the protective casing (C) it will be sufficient to remove the screws indicated in the photo that secure it to the oven.

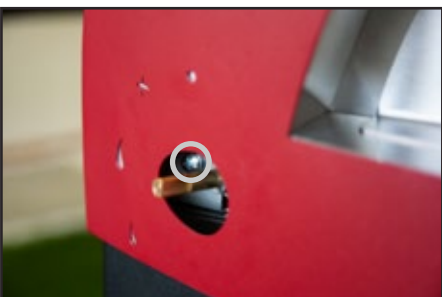

5. Remove the burner securing screw

Using a screwdriver, loosen the front securing screw of the burner. The screw's position and shape may vary depending on the oven model.



6 - Remove the burner

Now remove the burner halfway, being careful not to damage the ignition cable.



7. Remove the burner

Complete the removal by pulling the burner out along its full length.

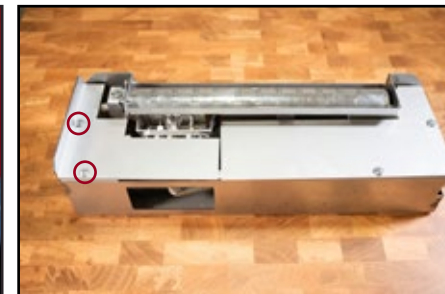

8 - Remove the cover

Remove part of the burner cover by unscrewing the two indicated screws.



9 - Loosen the air regulator

Loosen the screw on the air regulator to gain access to the main nozzle.

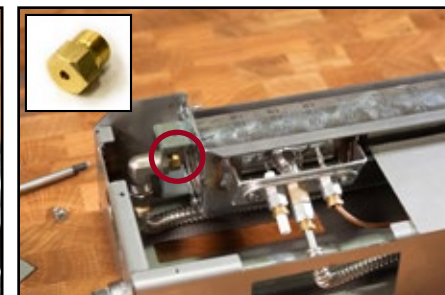

10 - Locate the nozzle to be replaced

Once the nozzle is identified, proceed with its replacement.

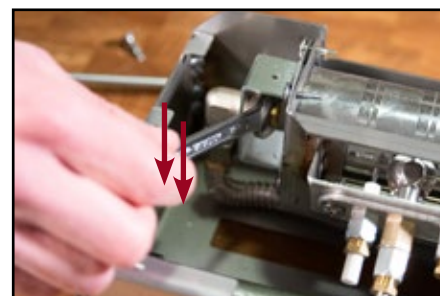

11 - Replace the nozzle

Use an 11mm wrench to remove the nozzle by unscrewing it like a regular nut (turn the wrench from top to bottom). Then, install (screw in) the new nozzle.



To watch the
conversion video

RESTORATION OF THE BURNER

TIP: Before reassembling the burner and all its parts, ensure that the power cable is correctly connected by activating the button located at the front.

NOTE: Reinsert the knob, paying attention to the valve pin. Apply slight pressure to push the knob into place.



1 - Partially reinsert the burner

From the lower front opening, insert the igniter cable. PARTIALLY insert the burner, guiding it to allow the igniter cable to slide smoothly.



2 - Reconnect the igniter cable

Connect the ignition cable to the igniter, taking care not to damage the cable or the connection.
TIP: Before reassembling the burner and all its components, check that the power cable is properly connected by pressing the front button.



3 - Fully insert the burner

Slide the burner into the guide until it reaches the front stop position. Ensure the igniter cable does not become tangled.

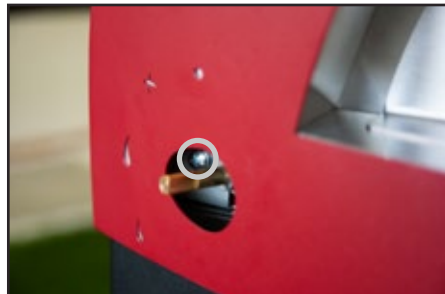

4 - Secure the burner fixing screw

At the front, near the knob position, tighten the screw to hold the burner securely in place.



5 - Attach the protective cover

Reposition the rear burner cover and tighten the fixing screws using a Phillips screwdriver.



6 - Reassemble the gas knob

Reinsert the knob, ensuring it aligns with the valve pin. Apply gentle pressure to fully seat the knob. Ensure the knob is in the "off" position.



7 - Reconnect the gas supply hose

Reconnect the supply hose to the rear burner manifold. You can now reopen the natural gas circuit or the LPG cylinder.

